

PUNK Rail Assembly Instructions

Hardware: 4 each hex nuts; 4 each flathead screws; 4 each flat washers. Tools required: Allen wrench.

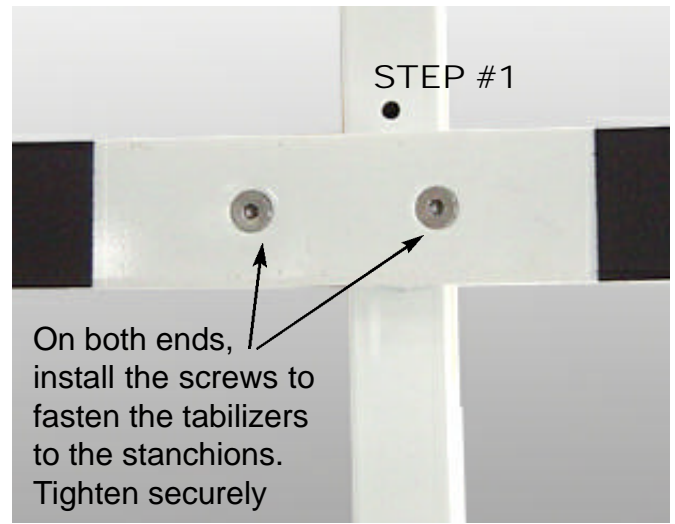

STEP #2



Couple the rail so the spring button is engaged.



The square-cut end of the Punk Rail has a spring button hole. This allows you, if you have two Punk Rails, to add them together. Note: when added together, the angled end of the second rail will be left over. The feature allows you to couple the square end of many Punk Rails into one long rail of almost unlimited length!

⚠️ WARNINGS:

USING A RAIL IS A DANGEROUS ACTIVITY AND MAY RESULT IN INJURY OR DEATH EVEN WHEN USED WITH PROPER SAFETY PRECAUTIONS. USE AT YOUR OWN RISK.

- Use this rail only on flat, dry, level ground without loose debris such as rocks or gravel.
- Do not place on slick or slippery surface. Check to ensure that feet securely grip your chosen surface.
- Do not exceed 220 pounds total weight (rider plus bike or scooter weight) on rail.
- Do not allow children under 8 years to use this rail. Older children and preteens must use with adult supervision at all times.
- Never use the ramp at dusk or night, or in wet or icy conditions
- Always wear proper protective equipment such as an ANSI, SNELL or ASTM approved helmet, and elbow and knee pads. Long sleeve shirt, long pants and lace-up athletic shoes are recommended.
- Never ride in traffic or on the street and watch your surroundings for pedestrians, bikes and scooter riders. Use this rail only in areas free from fixed or moving hazards such as poles, curbs, hydrants, walls, parked automobiles and traffic.
- Only intermediate and expert riders should use this rail.

WARRANTY

The manufacturer warrants this product to be free of manufacturing defects for a period of 30 days from date of purchase. This Limited Warranty does not cover normal wear and tear, scratches, bending nor any damage, failure or loss caused by improper assembly, maintenance, storage or use of the Punk Rail.

This Limited Warranty will be void if the product is ever modified in any way or rented.

Check local laws and regulations to see where

you can use your Punk Rail legally.

The manufacturer is not liable for incidental or consequential loss nor damage due directly or indirectly from the use of this product.

To obtain service under this warranty you must, within the warranty period, contact Razor USALLC directly by e-mail at warranty@razorusa.com. Razor will provide warranty replacement at its sole discretion. Authorized warranty service is ONLY available from Razor USA LLC.

